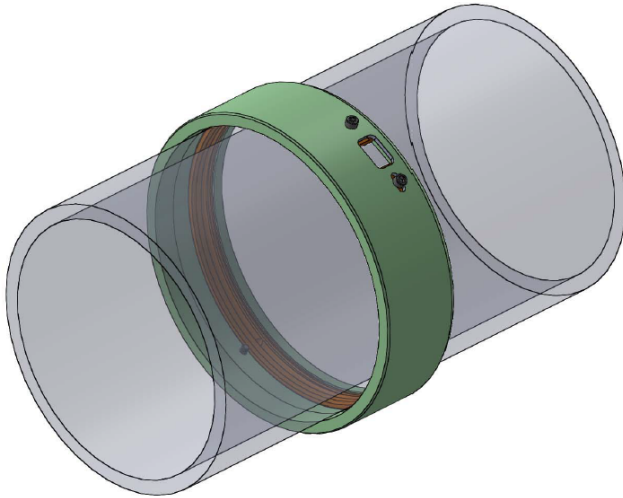
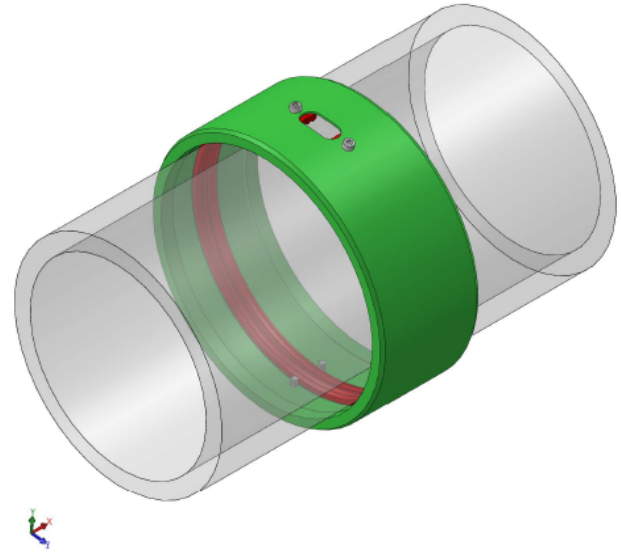

“Quick Grip” STOP COLLAR
Uni-Directional

“Quick Grip” STOP COLLAR
Bi-Directional

Features

- Locking mechanism remains fully contained under all conditions
- Minimalist design - only 2 working parts for Uni-Directional and 3 parts for Bi-Directional versions
- Fully Installed by the simple removal of shipping screws
- Non-welded carbon steel alloy construction
- Variable wedge energizing mechanism grip increases in direct response to applied load
- Higher performance than other slip-on collars
 - Standard ‘QG’ axial load rating is 100,000 lbs.
 - Slim line ‘QGS’ axial load rating is 65,000 lbs.
 - Passed an extensive qualification program

Benefits

- Easy to install / minimal training required
- Quick to install / saves time & expense
- No special setting tools required
- Safety: Eliminates hand safety hazard during installation
- Robust locking mechanism assures functionality when most needed (during critical loads events)

“Quick Grip” Stop Collar Specification Guide

CASING SIZE	SLIM-LINE VERSION Type “QGS”		STANDARD VERSION Type “QG”		Uni-Directional	Bi-Directional”
	Rating	OD *	Rating	OD **	Length	
4-1/2”	65,000 lbs +	4.989	100,000 lbs +	5.113	1.8	2.6
5”		5.506		5.630	1.9	2.7
5-1/2”		6.024		6.148	1.9	2.8
6-5/8”		7.188		7.312	2.0	2.9
7”		7.576		7.700	2.0	2.9
7-5/8”		8.223		8.347	2.0	3.0
7-3/4”		8.352		8.476	2.0	3.0
9-3/8”		10.034		10.158	2.1	3.2
9-5/8”		10.293		10.417	2.1	3.2
9-7/8”		10.552		10.676	2.1	3.3
9-7/8” (a)		10.506		N/A	2.1	3.0
10-1/8”		10.810		10.934	2.2	3.3
10-3/4”		11.457		11.581	2.2	3.4
11-3/4”		12.492		12.616	2.2	3.6
13-3/8”		14.158		14.282	2.3	3.6
13-5/8”		14.415		14.539	2.3	3.6
13-3/4”		14.543		14.667	2.3	3.6
13-7/8”		14.671		14.795	2.3	3.6
14”		14.799		14.923	2.3	3.7
16”		16.849		16.973	2.4	3.8
16.040”	16.890	17.034	2.4	3.8		
16.150”	17.003	17.167	2.4	3.8		
16.200”	17.238	17.178	2.4	3.8		

OD Tolerance as installed: * +/- 0.005”

* +/- 0.015”

(a) This size (Assembly 400415-08) is not designed for use where actual casing OD is less than 9.875”. All other sizes are fully compatible with casing that complies with API OD dimensional tolerances limits.

“Quick Grip” Stop Collar Ordering Information

CASING SIZE	SLIM-LINE VERSION Type “QGS”		STANDARD VERSION Type “QG”	
	Uni-Directional Part No.	Bi-Directional Part No.	Uni-Directional Part No.	Bi-Directional Part No.
4-1/2”	400419-01	400415-01	400401-01	400418-01
5”	400419-05	400415-02	400401-05	400418-02
5-1/2”	400419-02	400415-03	400401-02	400418-03
6-5/8”	400419-03	400415-04	400401-03	400418-04
7”	400419-04	400415-05	400401-04	400418-05
7-5/8”	400419-09	400415-10	400401-09	400418-10
7-3/4”	400419-15	400415-15	400401-15	400418-15
9-3/8”	400419-10	400415-06	400401-10	400418-06
9-5/8”	400419-06	400415-07	400401-07	400418-07
9-7/8”	400419-07	400415-21	400401-06	400418-21
9-7/8” (a)	N/A	400415-08 (a)	N/A	N/A
10-1/8”	400419-14	400415-14	400401-14	400418-14
10-3/4”	400419-11	400415-11	400401-11	400418-11
11-3/4”	400419-18	400415-18	400401-20	400418-20
13-3/8”	400419-12	400415-12	400401-12	400418-12
13-5/8”	400419-16	400415-16	400401-16	400418-16
13-3/4”	400419-21	400415-22	400401-20	400418-22
13-7/8”	400419-17	400415-17	400401-17	400418-17
14”	400419-13	400415-13	400401-13	400418-13
16”	400419-08	400415-09	400401-08	400418-09
16.040”	400419-19	400415-19	400401-18	400418-18
16.150”	400419-20	400415-20	400401-19	400418-19
16.200”	400419-22	400415-23	400401-23	400418-23

(a) This size (Assembly 400415-08) is not designed for use where actual casing OD is less than 9.875”. All other sizes are fully compatible with casing that complies with API OD dimensional tolerances limits.

For more information, please contact us
info@centergenics.com
 +1(844) **CENTER-8**
 +1(844) **236-8378**